

WIRING INSTRUCTIONS

TITLE

CIRCULAR SAW

**BULLETIN
58-01-0754**

MILWAUKEE ELECTRIC TOOL CORP. 13135 WEST LISBON RD. BROOKFIELD, WIS.

DATE
Feb. '98

Push all trapped wires into bottom of wire traps.

For Double Insulated Tools, Disregard wire #3 and T1.

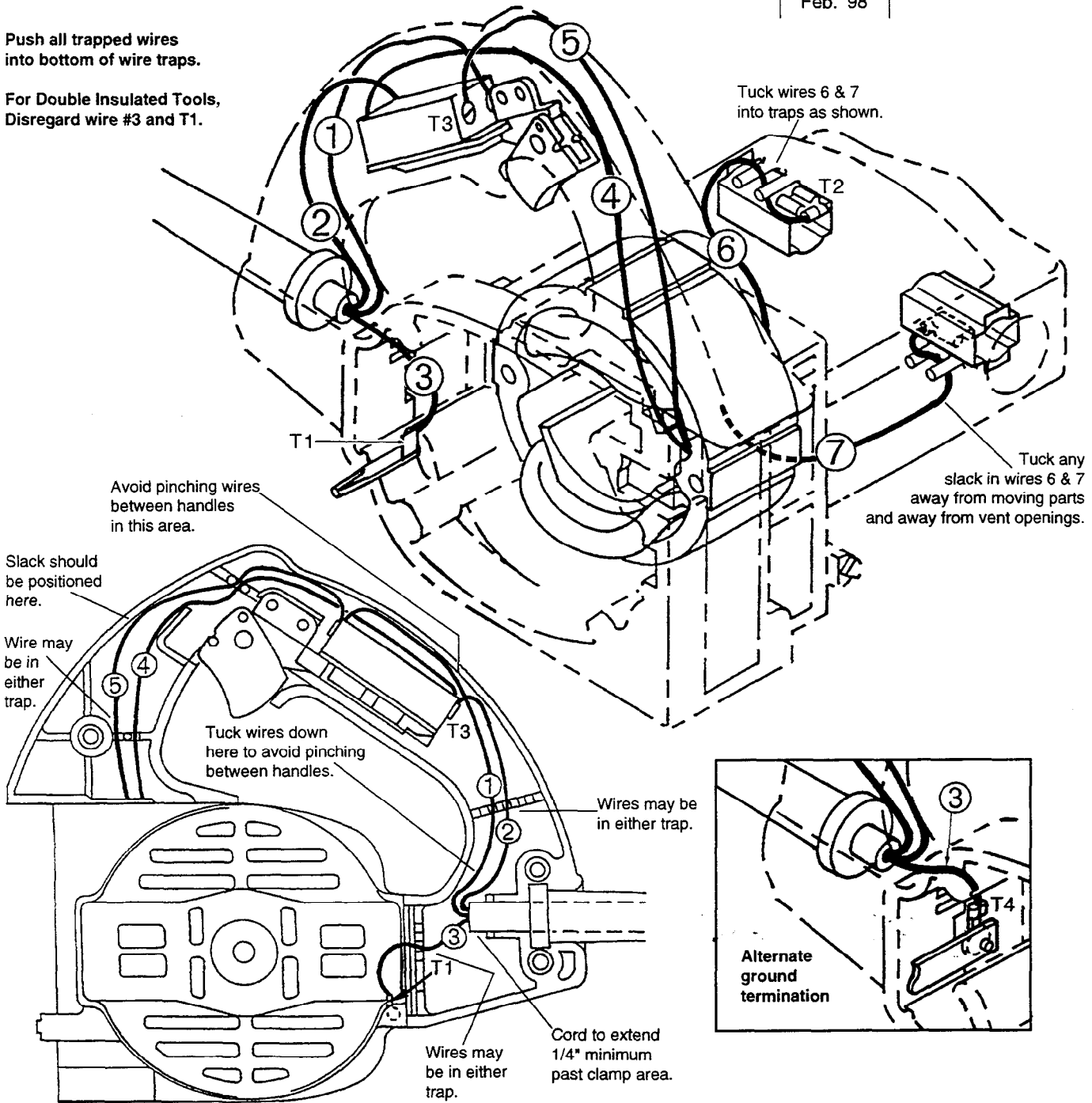

WIRING SPECIFICATIONS

Wire No.	Wire Color	Origin or Part No.	Gauge	Length	Terminals, Connectors and End Wire Preparation
1	White	Cord	14	7"	Strip 3/16" for T3.
2	Black	Cord	14	5"	Strip 3/16" for T3.
3	Green	Cord	14	2-1/4"	Strip 3/16" for T1.
4	Black	Field	16	10-7/8"	Strip 3/16" for T3.
5	Yellow	Field	16	8-7/8"	Strip 3/16" for T3.
6	Yellow	Field	16	3-1/2"	Strip 3/16" for T2.
7	Black	Field	16	3-1/2"	Strip 3/16" for T2.

NOTE:

All leads must be held to $\pm 1/8"$.
All lead lengths are before stripping.

TERMINAL DESCRIPTION

Code	Part No.	Qty.
T1	23-74-0625	1
T2	23-74-0610	2
T3	23-74-0850	4
T4	23-74-0850	1